

HT-4000 Series

HT-4000-M Monochrome

HT-4000-C Color

HT-4000-N Near IR



4MP 10GigE Camera with CMV4000 CMOS Sensor

HT-4000 features the CMV4000 sensor by AMS. Benefits include high sensitivity, high dynamic range, and high frame rate. At full resolution (2048 x 2048), you get 179 frames per second. With its 10GBaseT interface, sleek smaller case and CAT6A connection, this camera has the familiarity of GigE but with 10x the speed. Using CAT6A cabling, you can get cable lengths from 1 meter up to 100 meters. The HT-4000 offers multi-camera synchronization at <math><1\mu s</math>, low CPU overhead, and excellent price-performance ratio. A near-infrared option is available for this model.

Benefits

- » High-speed RJ45 10GBaseT interface
- » 10x the speed of GigE
- » GigE Vision® and Genicam™ compliant

Applications

- » Production lines
- » Microscopy Imaging

Specifications

Sensor	CMV4000
Resolution	2048 x 2048
Megapixels	4 MP
Sensor Type	1" CMOS
Max Frame Rate	179 fps
Cell Size	5.5µm square
Standard Mount	C Mount
Shutter	Global
Bit Depth	8 & 10 bit
GPIO / Triggering	3 in, 3 out Software, External (Pulse or Edge)
Interface	RJ45 10GBaseT
Exposure/Integration*	10µs-1s
Dynamic Range	60 dB
Monochrome Modes	Mono8, Mono10, Mono10Packed
Color Modes	RGB8, BGR8, YUV411, YUV422, YUV444
Raw Modes	BayerGB8, BayerGB10, BayerGB10Packed
Operating System	Win7/8/10 (64 bit), Linux (64 bit)
Compliance	CE, FCC, RoHS, WEEE, GigE Vision, GenICam
Power Requirements	9W, 12V
Operating Temperature	0C- 45C
Storage Temperature	-30C to +60C
Dimensions & Weight	88 x 58 x 39 - 275g
Warranty	2 Years

*all minimum exposure specs can vary from what is listed based on the limitations of each sensor as per notice from the manufacturer.

Mechanical drawings

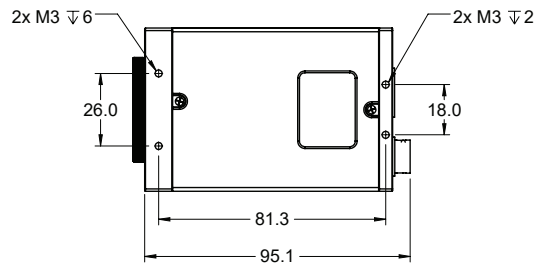
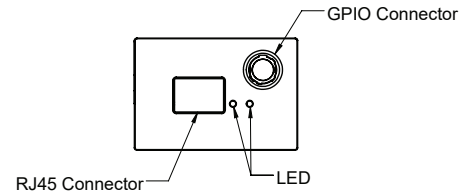
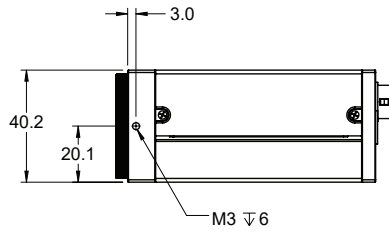
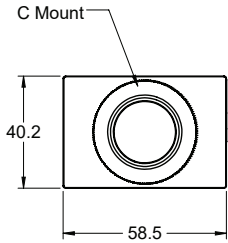
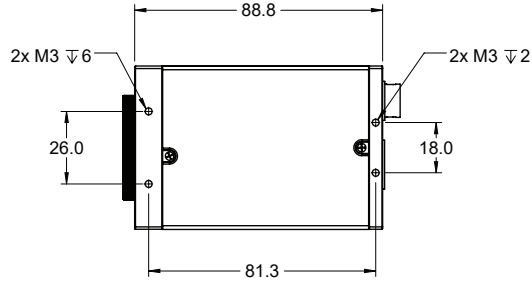

Spectral Sensitivity

