

HT-2000 Series

HT-2000-M Monochrome

HT-2000-C Color

HT-2000-N Near-IR



2MP 10GigE camera with CMV2000 CMOS sensor

HT-2000 features the CMV2000 CMOS sensor by AMS. Benefits include high dynamic range, and high frame rate. At full resolution (2048x1088) you get 338 frames per second. With its 10GBaseT interface, sleek smaller case and CAT6A connection, this camera has the familiarity of GigE but with 10x the speed. Using CAT6A cabling, you can get cable lengths from 1 meter up to 100 meters. The HT-2000 offers multi-camera synchronization at <math><1\mu s</math>, low CPU overhead, and excellent price-performance ratio. A near-infrared option is available for this model.

Benefits

- » High-speed RJ45 10GBaseT interface
- » 10x the speed of GigE
- » GigE Vision® and Genicam™ compliant

Applications

- » Production lines
- » Microscopy Imaging

Specifications

Sensor	CMV2000
Resolution	2048 x 1088
Megapixels	2MP
Sensor Type	2/3" CMOS
Max Frame Rate	338 fps
Cell Size	5.5µm square
Standard Mount	C Mount
Shutter	Global
Bit Depth	8 & 10 bit
GPIO / Triggering	3 in, 3 out Software, External (Pulse or Edge)
Interface	RJ45 10GBaseT
Exposure/Integration*	10µs-1s
Dynamic Range	60 dB
Monochrome Modes	Mono8, Mono10, Mono10Packed
Color Modes	RGB8, BGR8, YUV411, YUV422, YUV444
Raw Modes	BayerGB8, BayerGB10, BayerGB10Packed
Operating System	Win7/8/10 (64 bit), Linux (64 bit)
Compliance	CE, FCC, RoHS, WEEE, GigE Vision, GenICam
Power Requirements	9W, 12V
Operating Temperature	0C- 45C
Storage Temperature	-30C to +60C
Dimensions & Weight	88 x 58 x 39 - 275g
Warranty	2 Years

*all minimum exposure specs can vary from what is listed based on the limitations of each sensor as per notice from the manufacturer.

Mechanical drawings

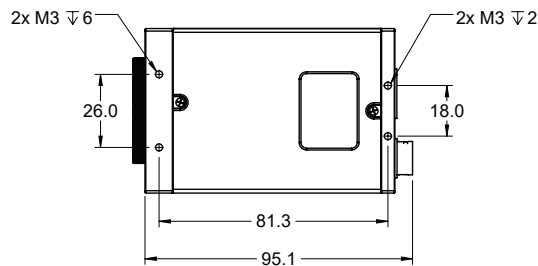
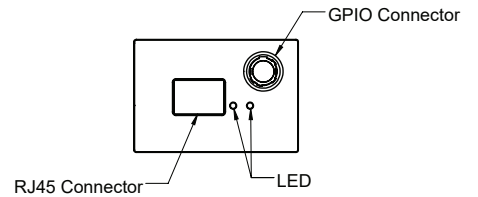
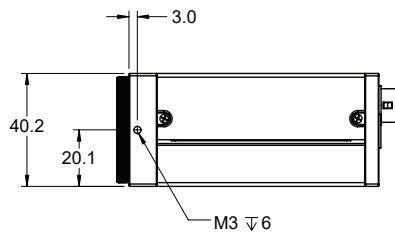
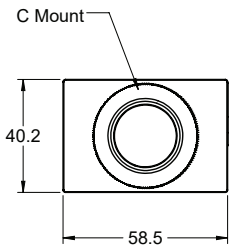
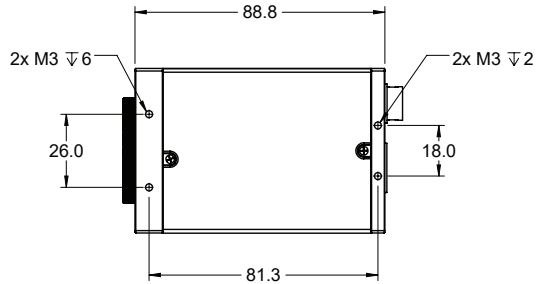

Spectral Sensitivity

